

Quick Installation Guide

Indoor/Outdoor Access Point



Scan for
EAP Start Guide

Note: EAP668-Outdoor HD is used as an example throughout the guide. Images may differ from your actual product.

©2026 TP-Link 7100003050 REV1.20.1

Package Contents

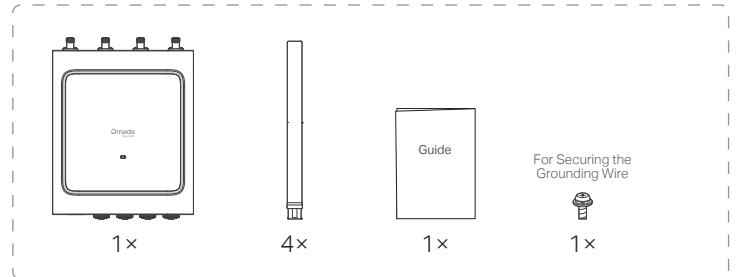

Waterproof Kit

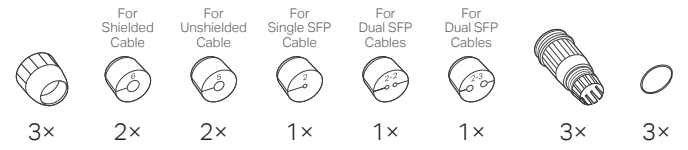

Mounting Kit

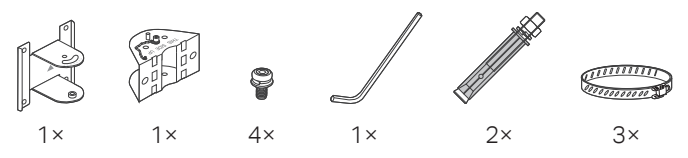

Note: Accessories may vary by region and model.

Installation

Option 1: Pole Mounting

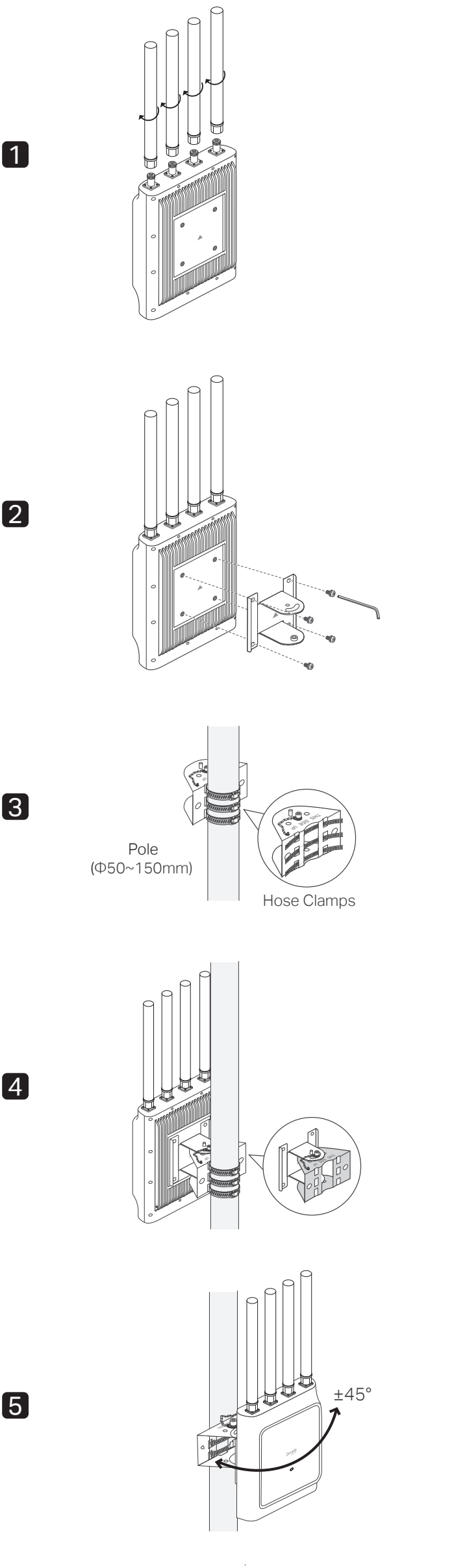
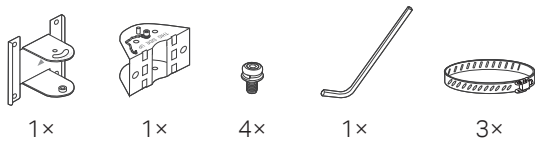

Option 2: Wall Mounting

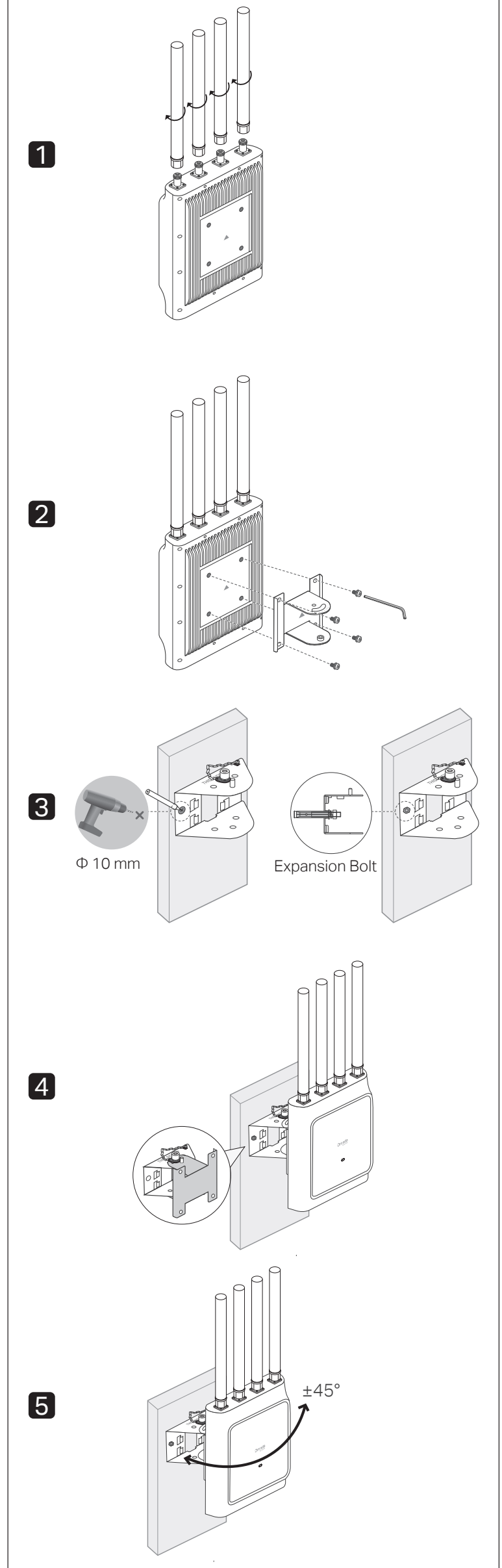
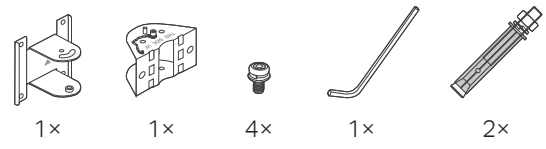

Tips:

- The included mounting kit supports horizontal rotation of $\pm 45^\circ$.
- For additional rotation options, you can purchase optional AP mount accessories as needed. For more information, go to <https://www.omadanetworks.com/business-networking/omada-accessory-ap-accessory/>

Hardware Connection

1. Waterproof

Connect the cables to the corresponding ports with the provided waterproof kit.

Note: The example below shows how to connect an Ethernet cable. If you also use the fiber-optic cable, you can connect it in a similar manner except for the type of seal.

! To maintain proper waterproofing, select the correct seal based on the actual cable type and outer diameter.

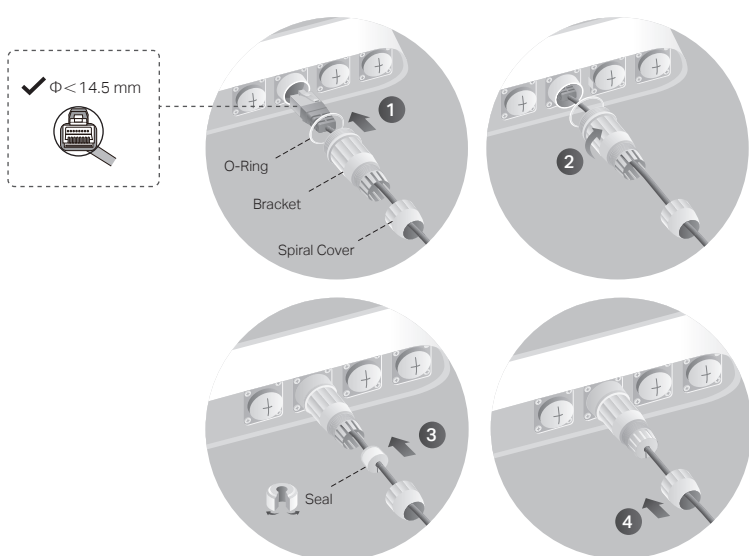

2. Grounding

Connect the EAP's grounding terminal to grounding facilities using a proper grounding wire.

- !**
1. Connect the protective earthing terminal to the installation's protective earthing conductor before powering on the device.
 2. The product must be installed by a qualified professional.
 3. The grounding connection should be in accordance with the requirements of local electrical code.
 4. The required size of the grounding wire should be at least 18AWG.
 5. The grounding conductor in contact with the protective earthing terminal should be copper tinned.

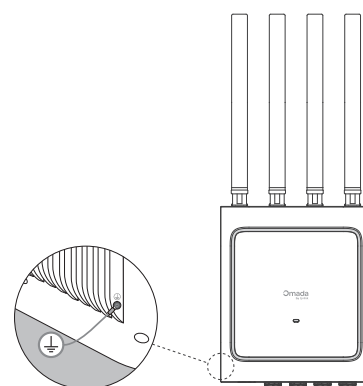

3. Connect to Network

The EAP can connect to the internet via an Ethernet and/or fiber network. You can choose the connection method according to your needs.

Option 1: Connect via Ethernet

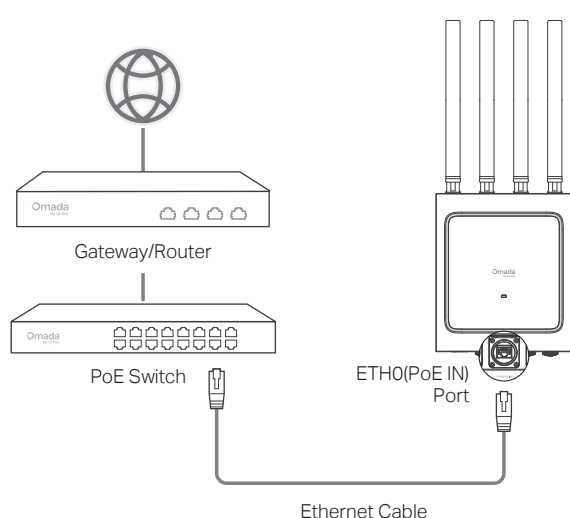

Option 2: Connect via Fiber Network

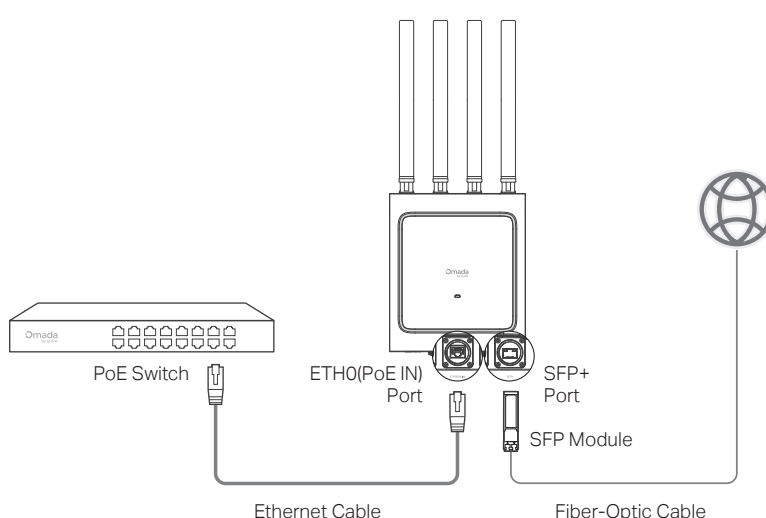

Configuration

Option 1: Standalone Mode

Configure and manage each EAP on its standalone page.

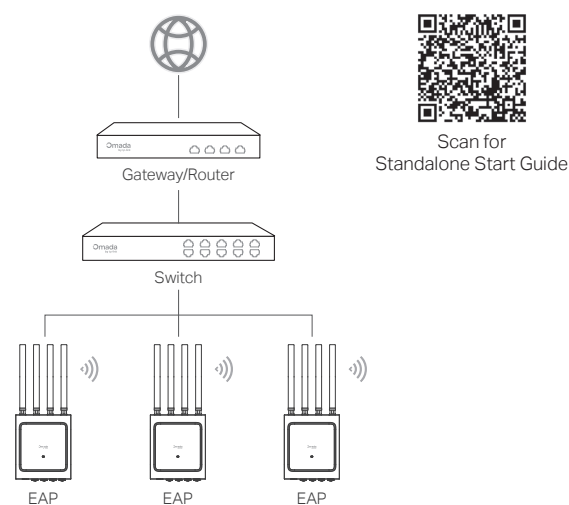

Option 2: Controller Mode

Configure and manage EAPs (and other Omada devices) centrally on an Omada Controller.

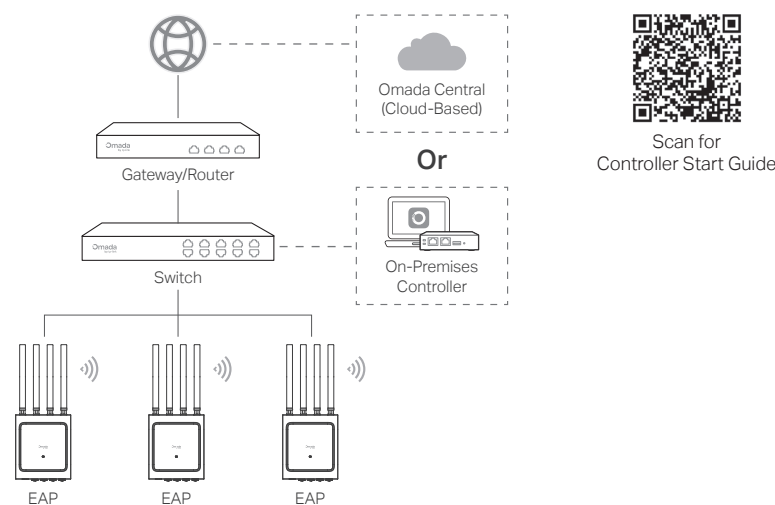

Omada App

With the TP-Link Omada app, you can access and manage your Omada devices at a local site or remotely with a tap of your phone.



More Configurations

For more configurations, refer to the User Guides of the Omada Controller and Omada Access Points at: <https://support.omadanetworks.com/document/>



Safety Information

- Keep the device away from fire or hot environments. DO NOT immerse in water or any other liquid.
- Do not attempt to disassemble, repair, or modify the device. If you need service, please contact us.
- Do not use the device where wireless devices are not allowed.
- The PoE ports shall not be used to charge lithium batteries or devices supplied by lithium batteries.
- This equipment can be powered only by equipments that comply with Power Source Class 2 (PS2) or Limited Power Source (LPS) defined in the standard of IEC 62368-1.

TP-Link hereby declares that the Access Point is in compliance with the essential requirements and other relevant provisions of directives 2014/53/EU, 2011/65/EU, and (EU)2015/863. The original EU Declaration of Conformity may be found at <https://www.tp-link.com/en/support/ce/>.

TP-Link hereby declares that the Access Point is in compliance with the essential requirements and other relevant provisions of the Radio Equipment Regulations 2017. The original UK Declaration of Conformity may be found at <https://www.tp-link.com/support/ukca/>

Attention: In EU member states, EFTA countries and Northern Ireland, the operation in the frequency range 5150MHz-5350MHz is only permitted indoors.

Attention: In Great Britain, the operation in the frequency range 5150MHz-5350MHz is only permitted indoors.

For the EAP Controller, go to the **Devices** page and select the desired EAP to specify the channel.

For the web browser, go to **Wireless > Wireless Settings** to specify the channel.

	AT	BE	BG	CH	CY	CZ	DE	DK		UK
	EE	EL	ES	FI	FR	HR	HU	IE		
	IS	IT	LI	LT	LU	LV	MT	NL		
	NO	PL	PT	RO	SE	SI	SK	UK(NI)		

More Resources

Main Site	https://www.omadanetworks.com/
Video Center	https://support.omadanetworks.com/video/
Documents	https://support.omadanetworks.com/document/
Product Support	https://support.omadanetworks.com/product/
Technical Support	https://support.omadanetworks.com/contact-support/

Warranty

For details on the warranty period, policy, and procedures, visit <https://support.omadanetworks.com/warranty-services/>.

Support

For technical support, user guides, and other information, please visit <https://support.omadanetworks.com/>, or simply scan the QR code.

